

## Specification

### DESIGN

Double eccentric design, low torque, long life, wafer flange connection.

### OPERATION

90° rotation of the handle, Each 10°lockable

### CONNECTION

Wafer,Lug,Flange

### FACE TO FACE LENGTH

API609

### PRESSURE RANGE

PN16-PN40:Class150-300

### TEMPERATURE RANGE

R-PTFE: -30°C - +200°C

PPL: -40°C - +250°C

PTFE: -30°C~120°C

### MATERIALS

Body: WCB  
CF8  
CF8M

Disc: WCB  
CF8  
CF8M

Packing: R-PTFE/PTFE/PPL

Seat: R-PTFE/PPL/PTFE

Handle: GGG40

### OPTIONS

Electrical position indicator  
Lengthened handle  
Handwheel device



Type:  
B200/B210/B220  
Manual double eccentric butterfly valve / ISO5211 platform double eccentric butterfly valve  
ANSI 150LB/300LB  
DIN PN16/PN25/PN40  
WCB  
CF8  
CF8M

The above information is for reference only and Aisenberg reserves the right to alter without prior notice

## Pressure - Temperature-Diagram

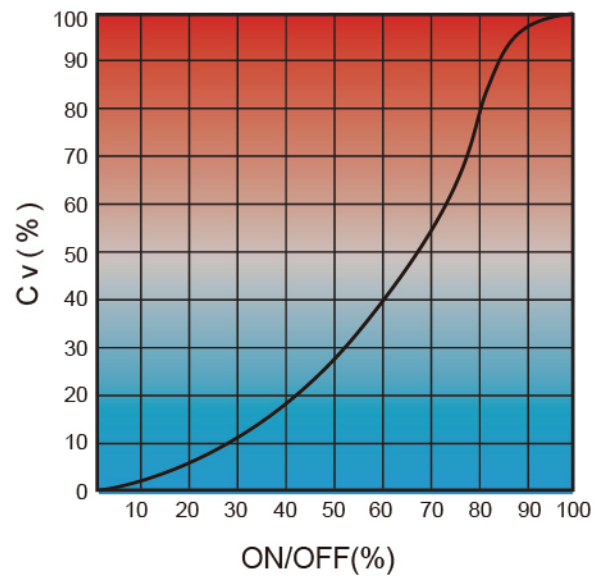

### 150LB

DN	10°	20°	30°	40°	50°	60°	70°	80°	90°
50	2	7	13	20	30	43	72	81	92
65	3	11	21	33	50	71	117	132	150
80	5	18	36	57	86	122	203	230	260
100	9	32	64	101	152	216	360	405	460
125	15	53	106	167	251	357	595	670	760
150	23	81	161	253	380	540	897	1015	1150
200	42	147	295	462	695	987	1640	1850	2100
250	64	225	450	705	1056	1505	2496	2816	3200
300	94	330	660	1035	1551	2210	3666	4136	4700
350	116	406	815	1276	1915	2726	4525	5105	5800
400	160	560	1120	1760	2640	3760	6240	7040	8000
450	210	735	1470	2310	3465	4935	8190	9240	10500
500	280	980	1960	3080	4620	6580	10920	12320	14000
600	420	1470	2940	4620	6930	9870	16380	18480	21000
750	878	1510	3600	6700	8183	12283	18511	25777	31140
900	1263	2260	5430	10200	11851	18165	26296	38060	48440

### 300LB

DN	10°	20°	30°	40°	50°	60°	70°	80°	90°
50	2	7	13	20	30	43	72	81	92
65	3	11	21	33	50	71	117	132	150
80	5	18	36	57	86	122	203	230	260
100	9	32	64	101	152	216	360	405	460
125	15	53	106	167	251	357	595	670	760
150	23	81	161	253	380	540	897	1015	1150
200	38	133	266	418	627	895	1485	1675	1900
250	56	196	392	616	925	1316	2185	2465	2800
300	82	287	575	905	1355	1930	3200	3610	4000
350	106	345	650	1054	1807	2630	4225	4863	4100
400	180	420	730	1160	1840	2970	4550	6540	7800
450	194	440	1080	1970	3110	4530	6170	8000	9500
500	260	530	1250	2330	3720	5400	7300	9570	11000
600	280	830	2000	3700	5920	8570	11400	15100	17875
750	295	1345	3278	6075	8560	13770	18900	24400	30708
900	390	1865	4560	9215	14830	22365	29900	38900	48008

## Model code

A	B	C	D	E	F	G	H	I	J
B200	B	D	6	6	P	P	B	D	15

A. Product	B. Control	C. Type of actuator	D. Body
B200=Wafered Double Eccentric Butterfly Valve B210=Lugged Double Eccentric Butterfly Valve B220=Flanged Double Eccentric Butterfly Valve	A=Manual B=Pneumatic Piston Actuator P=Basic Electric Actuator 0=NONE T=Electric intelligent F module X=Electric non-intelligent mechatronics H=Pneumatic scotch yoke standard type	L=Lever W=Handwheel U=ISO5211 Lever D=Double Acting S=Single Acting FC P=Single Acting FO E=220VAC Electric Actuator(ON/OFF) F=24VDC Electric Actuator(ON/OFF) M=380VAC Electric Actuator(ON/OFF) G=220VAC Electric Actuator(Control) H=24VDC Electric Actuator(Control) J=380VAC Electric Actuator(Control) K=220VAC Explosion Proof Electric Actuator(ON/OFF) N=24VDC Explosion Proof Electric Actuator(ON/OFF) Q=380VAC Explosion Proof Electric Actuator(ON/OFF) R=220VAC Explosion Proof Electric Actuator(Control) T=24VDC Explosion Proof Electric Actuator(Control) V=380VAC Explosion Proof Electric Actuator(Control) 0=NONE	2=WCB 4=CF8 6=CF8M

E. Trim	F. Seal	G. Packing	H. Pressure	I. Connection	J. Valve size
2=WCB 4=CF8 6=CF8M	A=PPL R=RPTFE P=PTFE	A=PPL R=RPTFE P=PTFE	B=PN16/150LB C=PN25 D=PN40/300LB	A=ASME FLANGE C=GB FLANGE D=DIN FLANGE	18=2" (DN50) 27=14" DN350 19=2 1/2" (DN65) 28=16" DN400 20=3" (DN80) 29=18" (DN450) 21=4" (DN100) 30=20" (DN500) 22=5" (DN125) 31=24" (DN600) 23=6" (DN150) 32=28" (DN700) 24=8" (DN200) 33=32" (DN800) 25=10" (DN250) 34=36" (DN900) 26=12" (DN300)

## Pressure - Temperature-Diagram

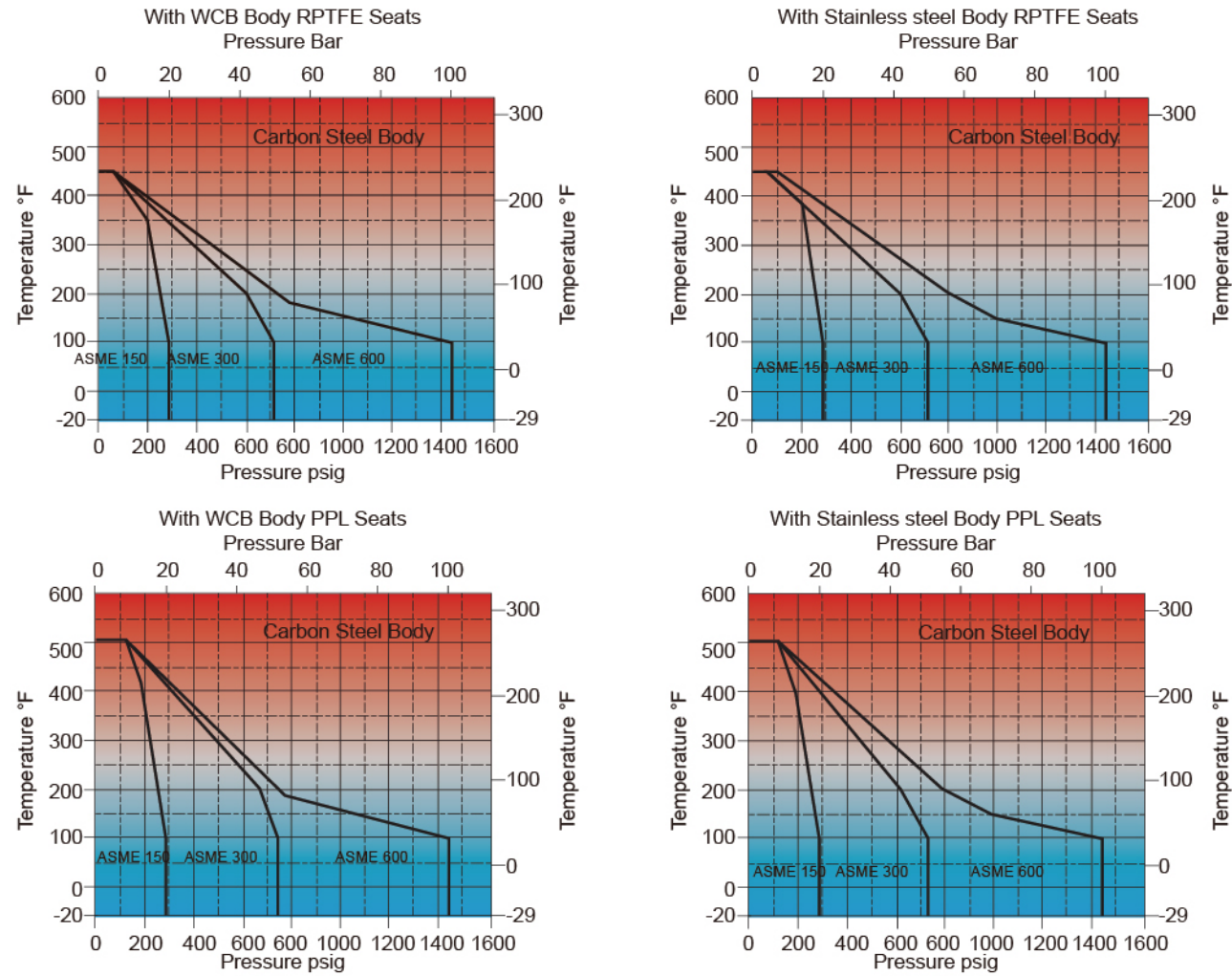

## Torque meter

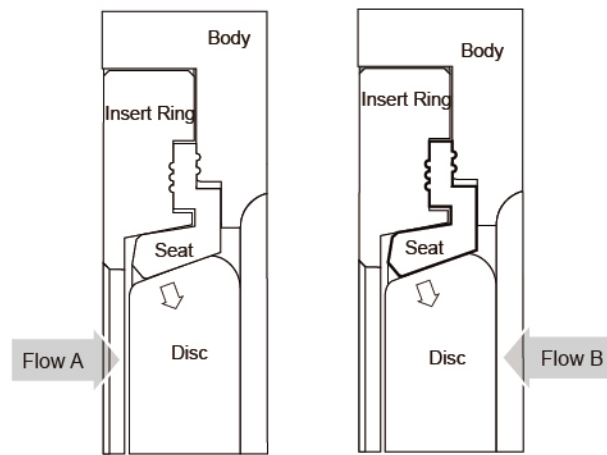

The direction of A is recommended

DN	ASME 150LB Torque (Nm) 17-20 bar		ASME 300LB Torque (Nm) 37-50 bar	
	Flow A	Flow B	Flow A	Flow B
	50	21	34	42
65	29	49	46	76
80	33	59	49	82
100	47	80	77	139
125	78	146	108	298
150	91	183	133	380
200	154	314	217	487
250	259	549	406	827
300	392	873	616	1132
350	644	1140	990	1993
400	945	1592	1390	2862
450	1225	2402	2339	4410
500	1760	3208	2640	5600
600	2640	3978	3600	8520
750	3750	8398	5637	12780
900	7710	12250	8130	13600

## Parts list

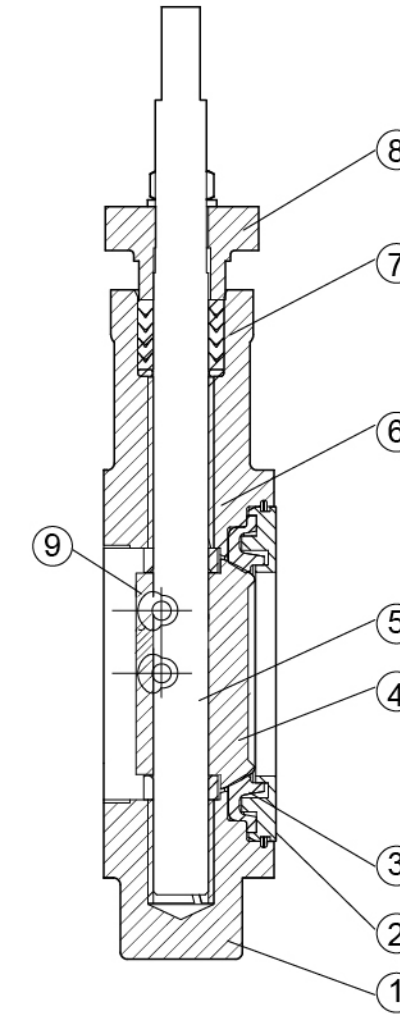

NO.	Description	Material
1	Body	WCB
		CF8
		CF8M
2	Insert	WCB
		CF8M
3	Seat	R-PTFE
		PPL
4	Disc	CF8
		CF8M
5	Stem	17-4PH
6	Shaft sleeve	F316+RPTFE
7	Packing	RPTFE
		PPL
8	Gland	WCB
		CF8
		CF8M
9	Wedge pin	17-4PH

Dimension

WAFER 150LB/PN16

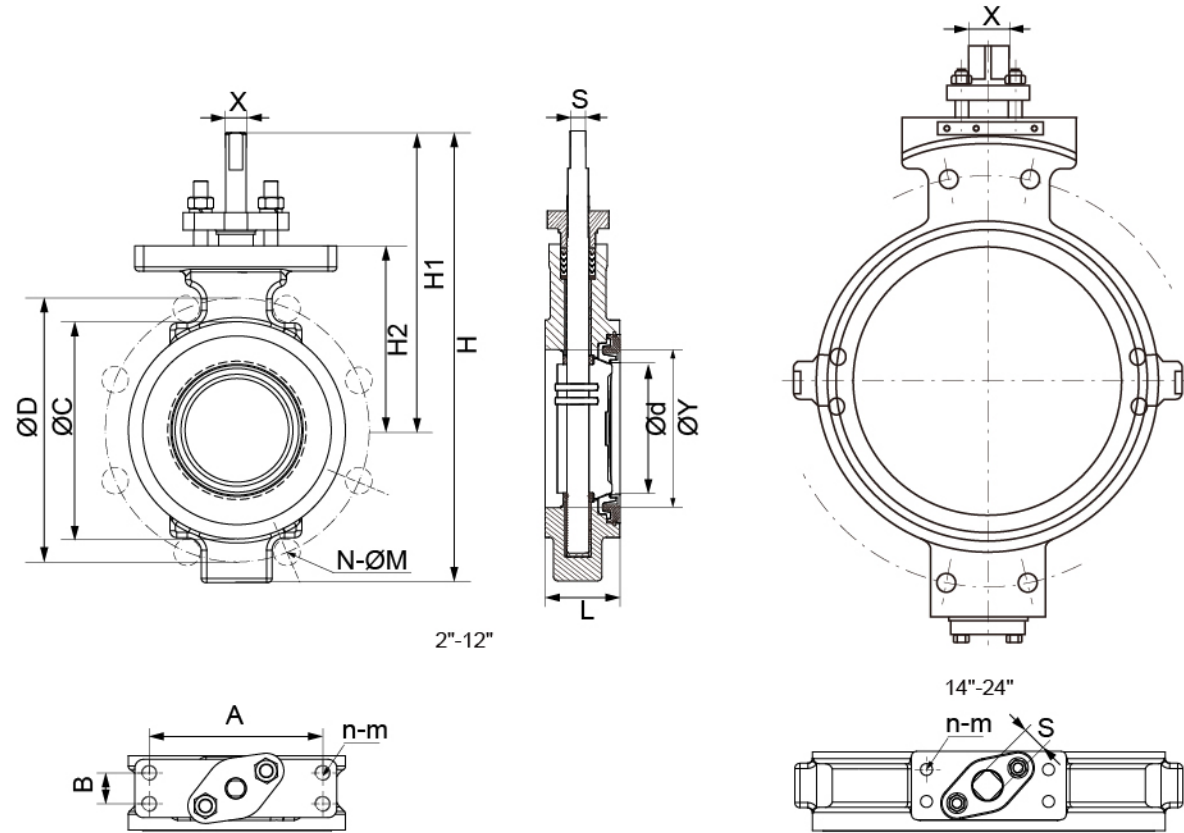

Dimension

LUG 150LB/PN16

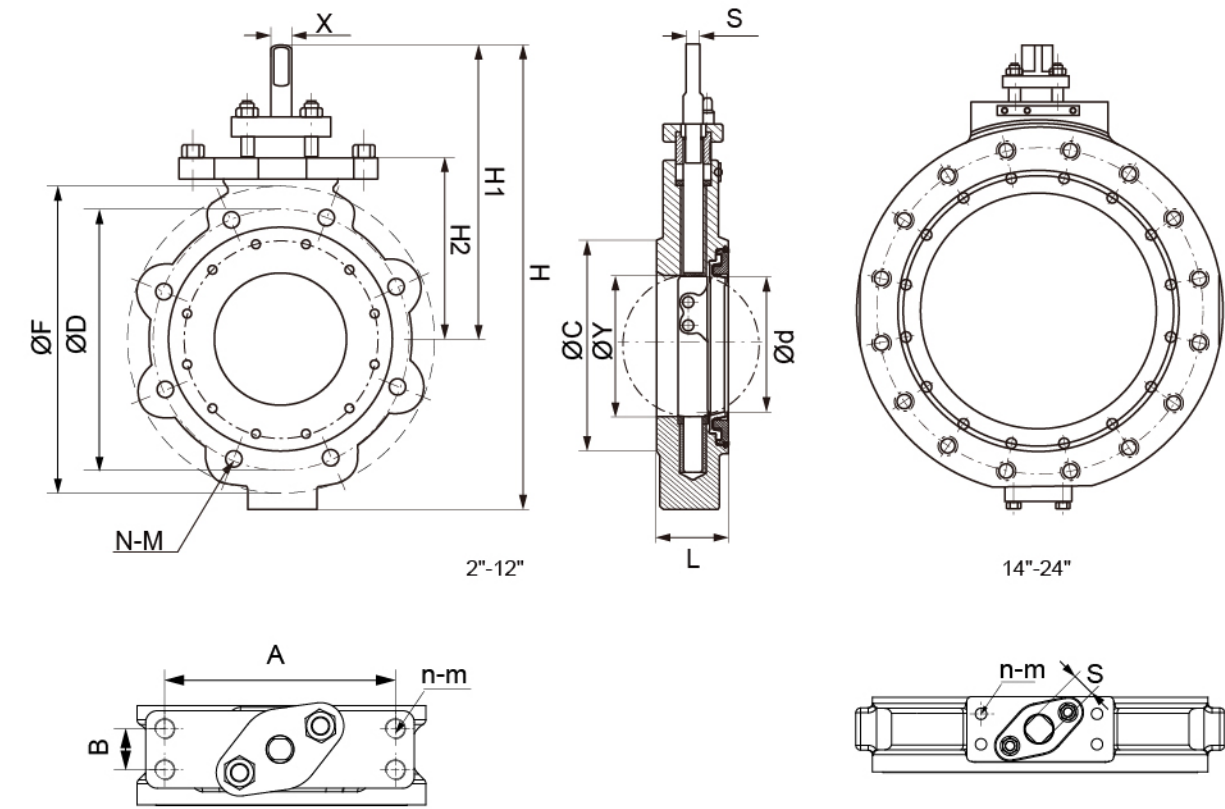

SIZE	DN	Ød	L	ØC	H1	H2	H	S	X	ØY	A	B	n-m	ØD		N-ØM	
														PN16	150LB	PN16	150LB
2"	50	38	43.3	96	124	80	186.3	7	24	50	125.5	22.4	4-M10	125	120.7	4-Ø18	4-Ø19
2 1/2"	65	59	49	119	194	111	275	11	16	48	125.5	22.4	4-M10	145	139.7	8-Ø18	4-Ø19
3"	80	73	49	132	203	121	316	11	16	74	125.5	22.4	4-M10	160	152.4	8-Ø18	4-Ø19
4"	100	95	54	157	216	133	341	11	16	97	125.5	22.4	4-M10	180	190.5	8-Ø18	8-Ø19
5"	125	111	64	186	217	135	362	11	16	111	125.5	22.4	4-M10	210	215.9	8-Ø18	8-Ø19
6"	150	142	57	216	235	152	384	13	19	146	125.5	22.4	4-M10	240	241.3	8-Ø22	8-Ø22
8"	200	188	64	270	270	187	464	16	22	194	125.5	22.4	4-M10	295	298.5	12-Ø22	8-Ø22
10"	250	236	71	324	325	232	560	21	29	243	142.8	37.4	4-M12	355	362	12-Ø26	12-Ø26
12"	300	282	81	381	359	260	632	24	35	289	142.7	37.3	4-M12	410	431.8	12-Ø26	12-Ø26
14"	350	314	92	413	394	309	705	29	41	318	141.3	37.4	4-M16	470	476.3	16-Ø26	12-Ø29
16"	400	363	102	470	421	332	742	41	48	365	203.2	82.6	4-M16	525	539.8	16-Ø30	16-Ø29
18"	450	414	114	533	449	356	802	41	54	416	203.2	82.6	4-M16	585	577.9	20-Ø30	16-Ø32
20"	500	456	127	584	467	378	842	41	60	454	203.2	82.6	4-M16	650	635	20-Ø33	20-Ø32
24"	600	549	154	692	607	490	1161	51	70	542	254	107.7	4-M20	770	749.3	20-Ø36	20-Ø35

Note: 2"-14" axis is a flat axis.

DN	Ød	L	ØC	H1	H2	H	S	X	ØY	F	A	B	n-m	ØD		N-M	
														PN16	150LB	PN16	150LB
50	38	43.3	82	124	80	186.3	7	24	50	117	125.5	22.4	4-M10	125	120.7	4-M16	4-M16
65	59	49	105	194	111	275	11	16	48	178	125.5	22.4	4-M10	140	139.7	8-M16	4-M16
80	73	49	132	203	121	316	11	16	74	191	125.5	22.4	4-M10	160	152.4	8-M16	4-M16
100	95	54	157	216	133	341	11	16	97	229	125.5	22.4	4-M10	180	190.5	8-M16	8-M16
125	111	64	186	217	135	341	11	16	111	264	125.5	22.4	4-M10	210	215.9	8-M16	8-M16
150	142	57	216	235	152	384	13	19	146	279	125.5	22.4	4-M10	240	241.3	8-M20	8-M20
200	188	64	270	270	187	464	16	22	194	343	125.5	22.4	4-M10	295	298.5	12-M20	8-M20
250	236	71	324	325	232	560	21	29	243	406	142.8	37.4	4-M12	355	362	12-M24	12-M22
300	282	81	381	359	260	632	24	35	289	483	142.7	37.3	4-M12	410	431.8	12-M24	12-M22
350	314	92	413	394	309	705	24	41	318	533	141.3	37.4	4-M16	470	476.3	16-M24	12-M27
400	363	102	470	421	332	742	41	48	365	597	203.2	82.6	4-M16	525	539.8	16-M27	16-M27
450	414	114	533	449	356	802	41	54	416	635	203.2	82.6	4-M16	585	577.9	20-M27	16-M30
500	456	127	584	467	378	842	41	60	454	699	203.2	82.6	4-M16	650	635	20-M30	20-M30
600	549	154	692	607	490	1161	51	70	542	813	254	107.7	4-M20	770	749.3	20-M33	20-M33

Note: 2"-14" axis is a flat axis.

Bolt holes are available in UN series, please consult aisenberg technical department for details.

Dimension

WAFER 300LB/PN25/PN40

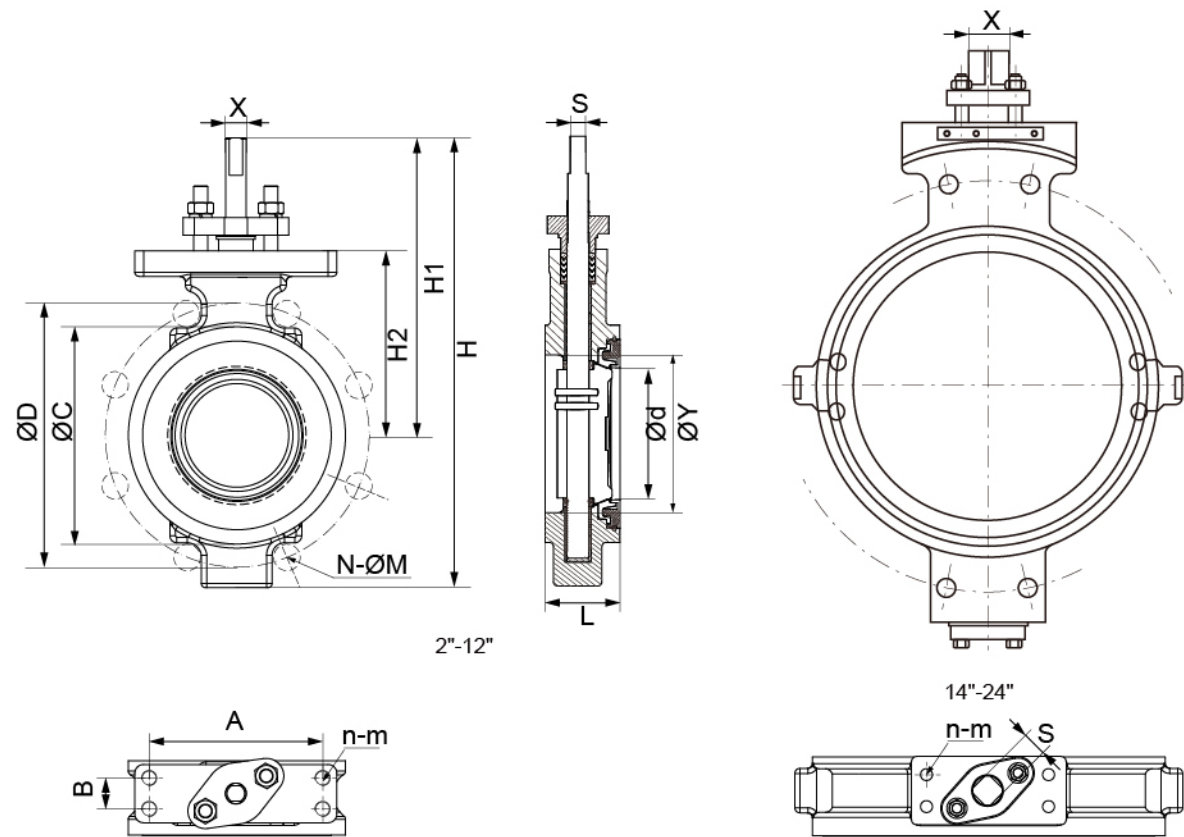

Dimension

LUG 300LB/PN25/PN40

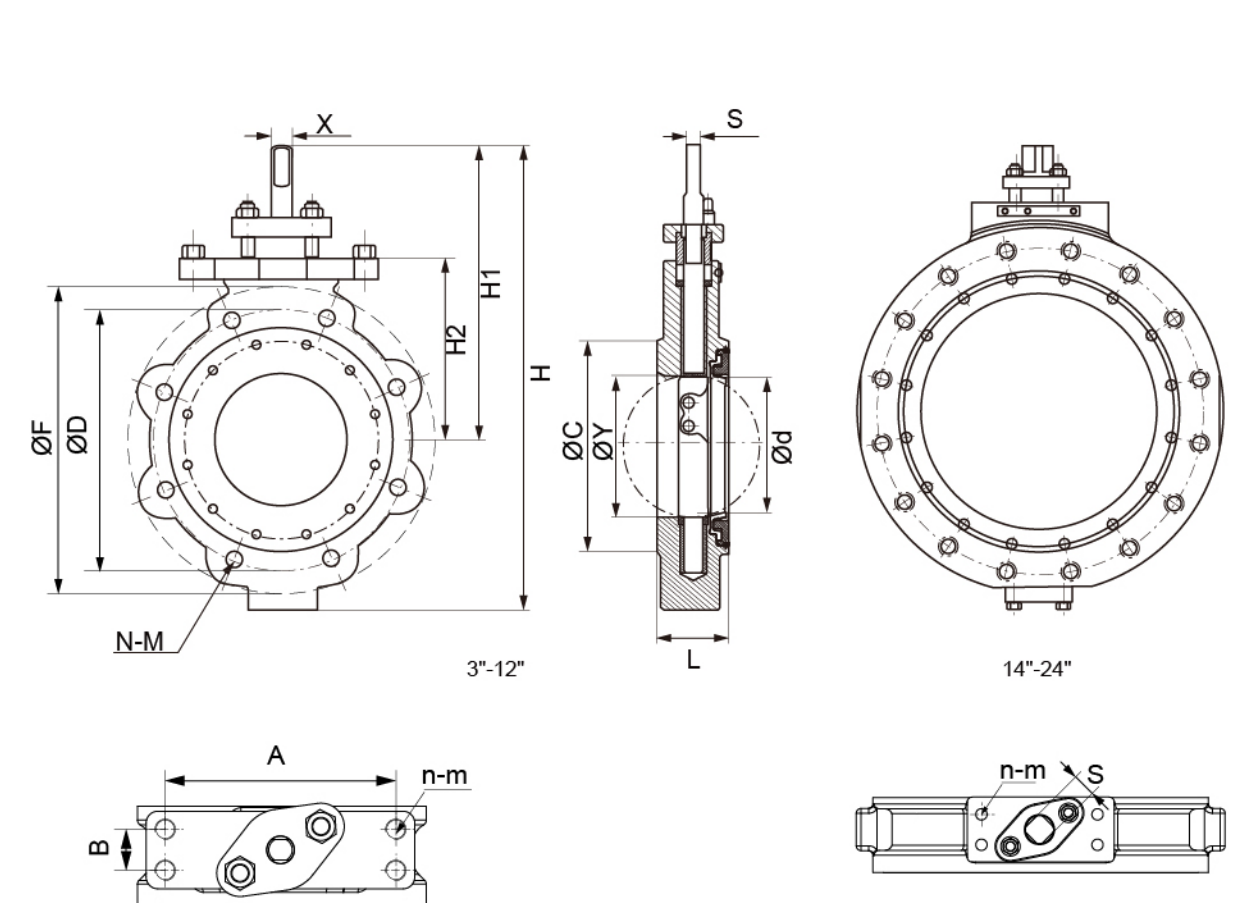

SIZE	DN	Ød	L	ØC	H1	H2	H	S	X	ØY	A	B	n-m	ØD			N-ØM		
														PN25	PN40	300LB	PN25	PN40	300LB
2"	50	38	43.3	96	124	80	186.3	7	24	50	125.5	22.4	4-M10	125	125	127	4-Ø18	4-Ø18	8-Ø18
2 1/2"	65	59	49	119	194	111	275	11.2	14.8	48	125.5	22.4	4-M10	145	145	149.2	8-Ø18	8-Ø18	8-Ø22
3"	80	73	49	132	203	121	316	11	16	74	125.5	22.4	4-M10	160	160	168.3	8-Ø18	8-Ø18	8-Ø22
4"	100	95	54	157	216	133	341	11	16	97	125.5	22.4	4-M10	190	190	200	8-Ø22	8-Ø22	8-Ø22
5"	125	111	64	186	217	135	326	11.2	14.8	111	125.5	22.4	4-M10	220	220	235	8-Ø26	8-Ø26	8-Ø22
6"	150	142	59	216	257	175	413	16	22	146	125.5	22.4	4-M10	250	250	269.9	8-Ø26	8-Ø26	12-Ø22
8"	200	188	73	270	306	213	495	21	29	194	142.7	37.3	4-M12	310	320	330.2	12-Ø26	12-Ø30	12-Ø26
10"	250	236	83	324	353	254	592	24	35	243	142.7	37.3	4-M12	370	385	387.4	12-Ø30	12-Ø33	16-Ø30
12"	300	282	92	381	389	283	675	29	41	289	142.7	37.3	4-M12	430	450	450.8	16-Ø30	16-Ø33	16-Ø33
14"	350	314	117	413	417	325	730	41	54	298	203.2	82.6	4-M16	490	510	514.4	16-Ø33	16-Ø36	20-Ø33
16"	400	363	133	470	440	351	781	41	54	346	203.2	82.6	4-M16	550	585	571.5	16-Ø36	16-Ø39	20-Ø36
18"	450	414	149	533	542	424	960	51	70	392	254	82.6	4-M20	600	610	628.6	20-Ø36	20-Ø39	24-Ø36
20"	500	456	162	584	574	447	1015	51	89	433	254	82.6	4-M20	660	670	685.8	20-Ø36	20-Ø42	24-Ø36
24"	600	549	184	692	634	501	1141	51	102	524	254	82.6	4-M20	770	795	812.8	20-Ø39	20-Ø48	24-Ø42

SIZE	DN	Ød	L	ØC	H1	H2	H	S	X	ØY	F	A	B	n-m	ØD			N-ØM		
															PN25	PN40	300LB	PN25	PN40	300LB
3"	80	73	49	132	203	121	316	11	16	74	207	125.5	22.4	4-M10	160	160	168.3	8-M16	8-M16	8-M20
4"	100	95	54	157	216	133	341	11	16	97	238	125.5	22.4	4-M10	190	190	200	8-M20	8-M20	8-M20
5"	125	111	64	186	235	153	362	13	14.8	111	279	125.5	22.4	4-M10	220	220	235	8-M24	8-M24	8-M20
6"	150	142	59	216	257	175	413	16	22	146	308	125.5	22.4	4-M10	250	250	269.9	8-M24	8-M24	12-M20
8"	200	188	73	270	306	213	495	21	29	194	381	142.7	37.3	4-M12	310	320	330.2	12-M24	12-M27	12-M22
10"	250	236	83	324	353	254	592	24	35	243	445	142.7	37.3	4-M12	370	385	387.4	12-M27	12-M30	16-M27
12"	300	282	92	381	389	283	675	29	41	289	514	142.7	37.3	4-M12	430	450	450.8	16-M27	16-M30	16-M30
14"	350	314	117	413	417	325	730	41	54	298	584	203.2	82.6	4-M16	490	510	514.4	16-M30	16-M33	20-M30
16"	400	363	133	470	440	351	781	41	54	346	648	203.2	82.6	4-M16	550	585	571.5	16-M33	16-M36	20-M33
18"	450	414	149	533	542	424	960	51	70	392	711	254	82.6	4-M20	600	610	628.6	20-M33	20-M36	24-M33
20"	500	456	162	584	574	447	1015	51	89	433	775	254	82.6	4-M20	660	670	685.8	20-M33	20-M39	24-M33
24"	600	549	184	692	634	501	1141	51	102	524	914	254	82.6	4-M20	770	795	812.8	20-M36	20-M45	24-M39

Note: 3"-14" axis is a flat axis.  
Bolt holes are available in UN series, please consult aisenberg technical department for details.

**B200/B210/B220 series pneumatic double eccentric butterfly valve**

**Aisenberg®**

**Aisenberg®**

**Specification**

**DESIGN**

Double eccentric design, low torque, long life, wafer flange connection.

**OPERATION**

Pneumatic double-acting or single-acting

**CONNECTION**

Wafer, Lug, Flange

**FACE TO FACE LENGTH**

API609

**PRESSURE RANGE**

PN16-PN40: Class150-300

**TEMPERATURE RANGE**

R-PTFE: -30°C - +200°C

PPL: -40°C - +250°C

PTFE: -30°C~120°C

**MATERIALS**

Body: WCB  
CF8  
CF8M

Disc: WCB  
CF8  
CF8M

Packing: R-PTFE/PTFE/PPL

Seat: R-PTFE/PPL/PTFE

Handle: GGG40

**EXTERNAL TEMPERATURE RANGE**

-20°C - +70°C

**PILOT MEDIA**

Filtered gases (oil, ash and water removal)

**OPTIONS**

3/2-ways or 5/2-ways valve, limit switch, positioner, filter reducer, manual clutch

The above information is for reference only and Aisenberg reserves the right to alter without prior notice



Type:  
B200/B210/B220  
Pneumatic double eccentric butterfly valve  
150LB/300LB  
PN16/PN25/PN40

WCB  
CF8  
CF8M

**Dimension**

150LB/PN16

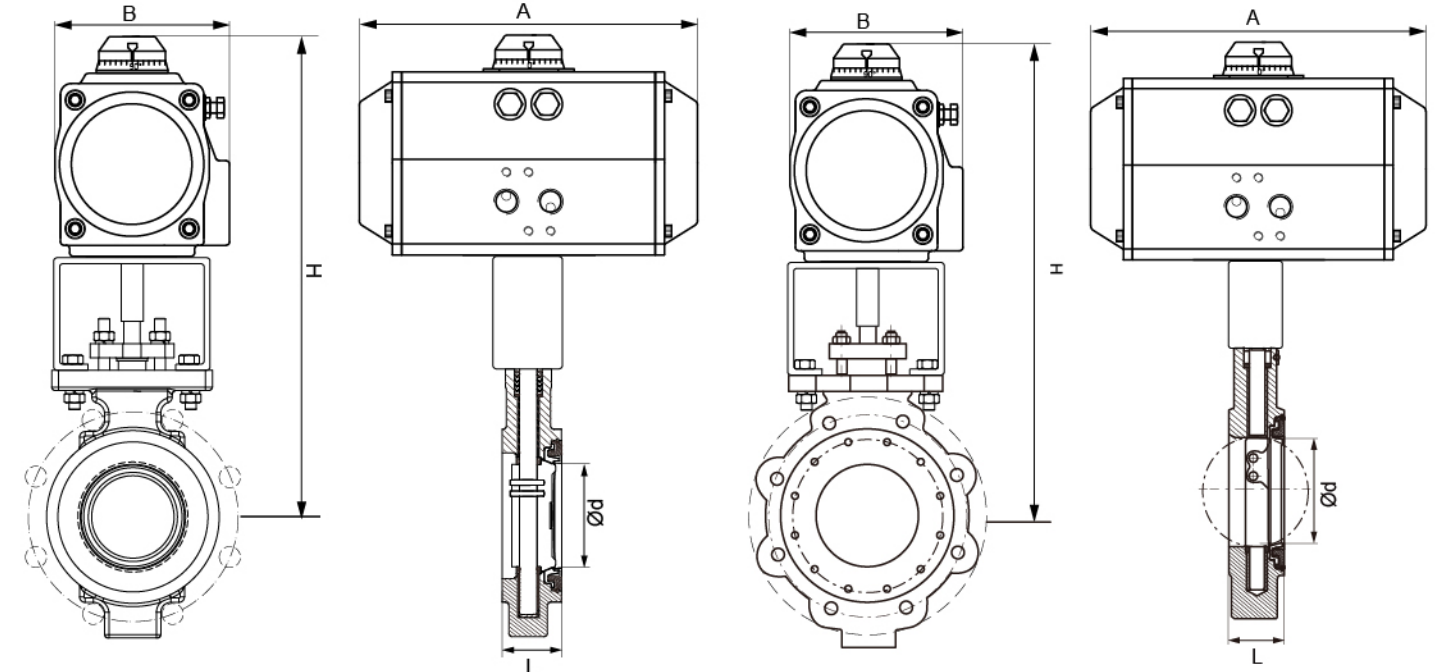

WAFER 2"-24"

LUG 2"-24"

SIZE	DN	Ød	L	Actuator Model	A	B	H
2"	50	38	43.3	DA63	172	83	292.3
				SR75	184	95	304.3
2 1/2"	65	59	49	DA75	184	95	374
				SR83	204	103	383
3"	80	73	49	DA75	184	95	383
				SR92	262	109	400
4"	100	95	54	DA83	204	103	405
				SR105	268	121	429
5"	125	111	64	DA92	262	109	414
				SR125	301	143	452
6"	150	142	57	DA105	268	121	448
				SR140	394	152	498
8"	200	188	64	DA125	301	143	505
				SR160	458	174	548
10"	250	236	71	DA140	394	152	588
				SR160	458	174	603
12"	300	282	81	DA160	458	174	637
				SR190	528	206	671
14"	350	314	92	DA190	528	206	706
				SR210	532	226	731
16"	400	363	102	DA210	532	226	758
				SR240	660	260	792
18"	450	414	114	DA240	660	260	820
				SR270	740	294	859
20"	500	456	127	DA240	660	260	838
				SR300	798	336	901
24"	600	549	154	DA270	740	294	1017
				SR350	880	385	1095

Note: Above information is under normal working condition, Please consult the technical department in case of special working conditions

## Dimension

300LB/PN25/PN40

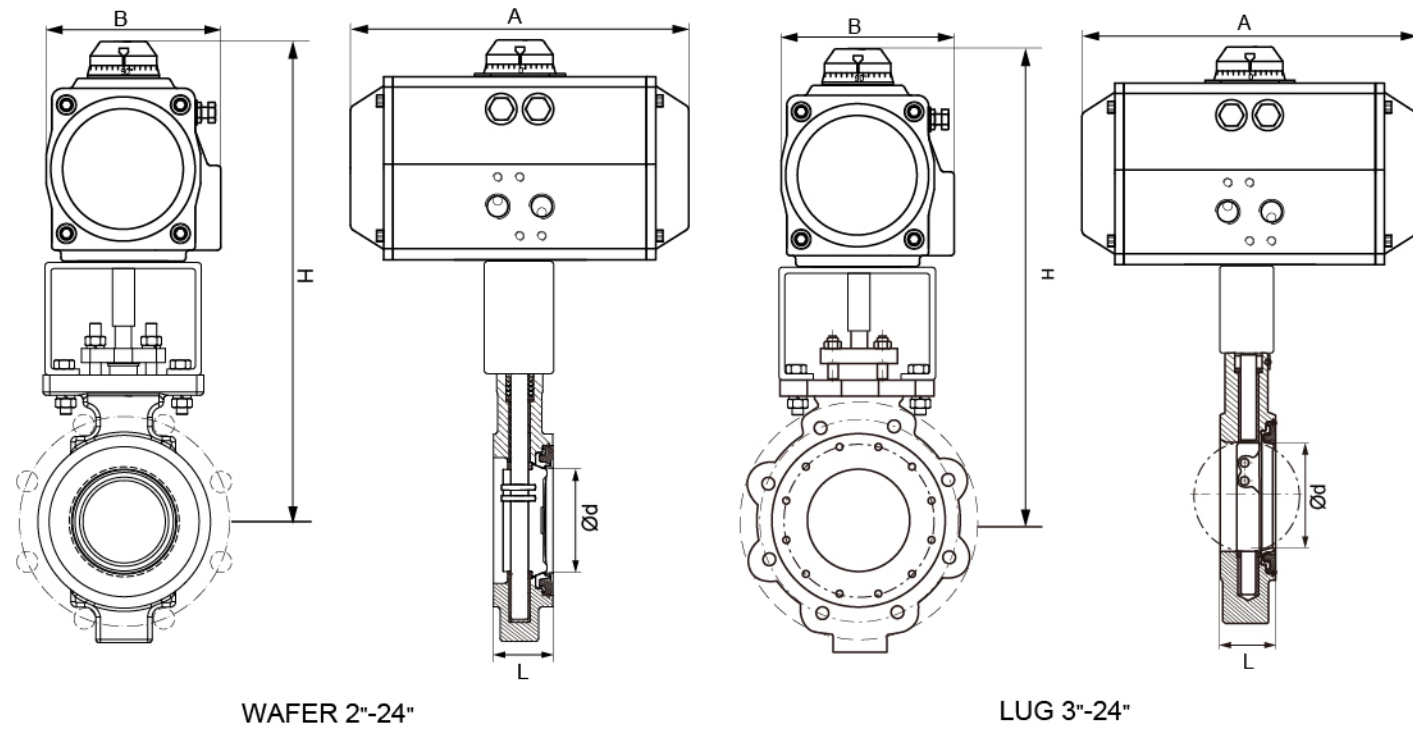

WAFER 2"-24"

LUG 3"-24"

SIZE	DN	Ød	L	Actuator Model	A	B	H
2"	50	38	43.3	DA75	184	95	304.3
				SR92	262	109	321.3
2 1/2"	65	59	49	DA83	204	103	383
				SR92	262	109	391
3"	80	73	49	DA83	204	103	392
				SR105	268	121	416
4"	100	95	54	DA92	262	109	413
				SR125	301	143	451
5"	125	111	64	DA105	268	121	430
				SR140	394	152	370
6"	150	142	59	DA125	301	143	492
				SR140	394	152	510
8"	200	188	73	DA140	394	152	559
				SR190	528	206	618
10"	250	236	83	DA160	458	174	631
				SR210	532	226	700
12"	300	282	92	DA190	528	206	701
				SR240	660	260	760
14"	350	314	117	DA240	660	260	788
				SR270	740	336	827
16"	400	363	133	DA270	740	294	850
				SR300	798	336	874
18"	450	414	149	DA270	740	294	952
				SR350	880	385	1030
20"	500	456	162	DA300	798	336	1008
				SR400	950	516	1118
24"	600	549	184	DA350	880	385	1122
				SR400	950	516	1178

Note: Above information is under normal working condition, Please consult the technical department in case of special working conditions

## B200/B210/B220 series pneumatic double eccentric butterfly valve

**Aisenberg®**

### Specification

#### DESIGN

Double eccentric design, low torque, long life, wafer flange connection.

#### OPERATION

Electric with handle operation

#### CONNECTION

Wafer, Lug, Flange

#### FACE TO FACE LENGTH

API609

#### PRESSURE RANGE

PN16-PN40: Class150-300

#### TEMPERATURE RANGE

R-PTFE: -30°C - +200°C

PPL: -40°C - +250°C

PTFE: -30°C~120°C

#### EXTERNAL TEMPERATURE RANGE

-20°C - +70°C

#### OPTIONAL VOLTAGE

24V DC, 24V AC, 110V AC, 220V AC, 380V AC

#### PROTECTION

IP 67

#### STANDARD EQUIPMENT

Additional limit switches, optical position indicator, manual override, On/Off+Limit switch

#### OPTIONS

Potentiometer modulate type 4-20mA

Exd IIB T4 for more requests please contact us

The above information is for reference only and Aisenberg reserves the right to alter without prior notice



Type:  
B200/B210/B220  
Electric double eccentric  
butterfly valve  
150LB/300LB  
PN16/PN25/PN40

WCB  
CF8  
CF8M

#### MATERIALS

Body: WCB  
CF8  
CF8M

Disc: WCB  
CF8  
CF8M

Packing: R-PTFE/PTFE/PPL

Seat: R-PTFE/PPL/PTFE

Handle: GGG40

**Dimension**  
150LB/PN16

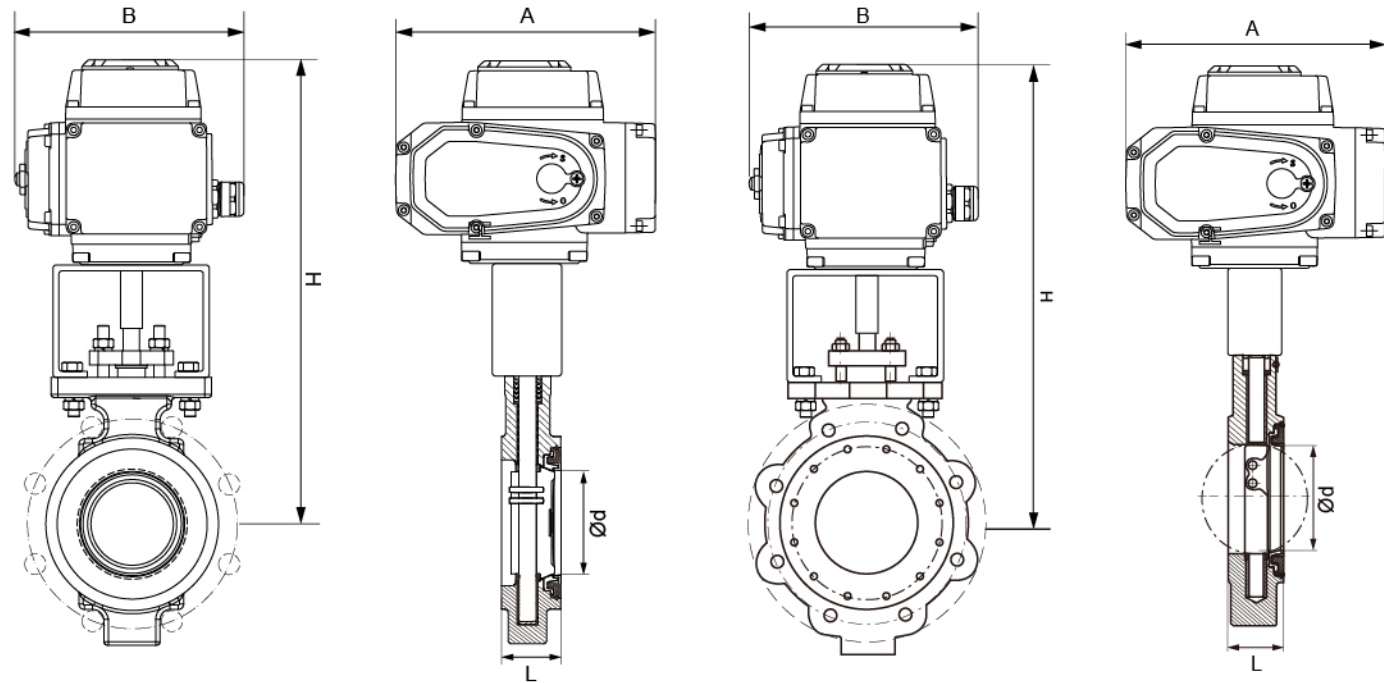

WAFER 2"-24"

LUG 2"-24"

**Dimension**  
LUG 300LB/PN25/PN40

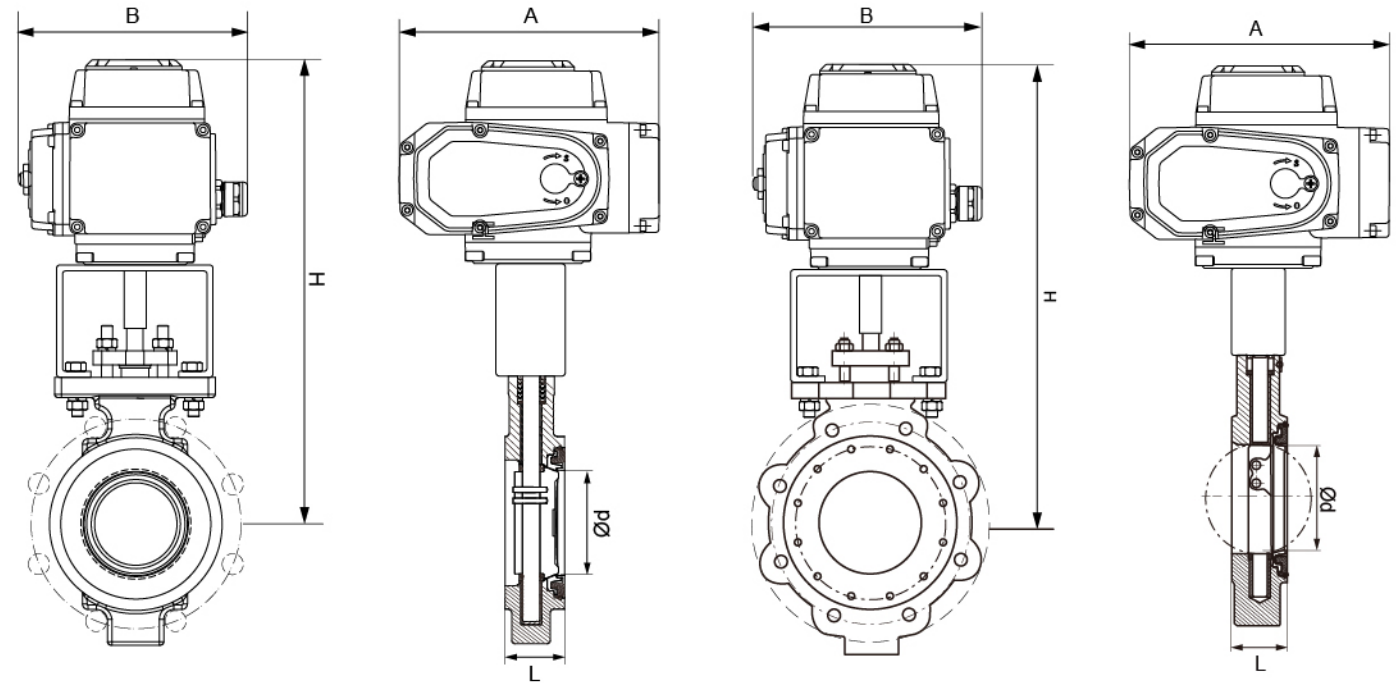

WAFER 2"-24"

LUG 3"-24"

**Aisenberg®**

SIZE	DN	Ød	L	Actuator Model	A	B	H
2"	50	38	43.3	HB50	165.0	140.5	311.8
				HBX50	170.5	121	324.3
2 1/2"	65	59	49	HB50	165.0	140.5	381.5
				HBX50	170.5	121	394
3"	80	73	49	HB50	165.0	140.5	390.5
				HBX50	170.5	121	403
4"	100	95	54	HB100	211.5	154	434.5
				HBX100	217.5	139	448
5"	125	111	64	HB100	211.5	154	435.5
				HBX100	217.5	139	449
6"	150	142	57	HB200	259	186	488
				HBX200	217.5	139	467
8"	200	188	64	HB400	259	186	523
				HBX400	266.5	170	533
10"	250	236	71	HB400	259	186	578
				HBX400	266.5	170	588
12"	300	282	81	HB600	259	186	612
				HBX600	266.5	170	622
14"	350	314	92	HB1000	283	173	673.5
16"	400	363	102	HB2000	283	173	700.5
18"	450	414	114	HB2000	283	173	728.5
20"	500	456	127	HB2000	283	173	746.5

SIZE	DN	Ød	L	Actuator Model	A	B	H
2"	50	38	43.3	HB50	165.0	140.5	311.8
				HBX50	170.5	121	324.3
2 1/2"	65	59	49	HB100	211.5	154	412.5
				HBX100	217.5	139	426
3"	80	73	49	HB100	211.5	154	421.5
				HBX100	217.5	139	435
4"	100	95	54	HB200	259	186	469
				HBX200	217.5	139	448
5"	125	111	64	HB200	259	186	470
				HBX200	217.5	139	449
6"	150	142	59	HB400	259	186	510
				HBX400	266.5	170	520
8"	200	188	73	HB600	259	186	559
				HBX600	266.5	170	569
10"	250	236	83	HB1000	283	173	632.5
12"	300	282	92	HB1000	283	173	668.5
14"	350	314	117	HB2000	283	173	696.5
16"	400	363	133	HB2000	283	173	719.5
18"	450	414	149	HB2000	283	173	821.5